



CPR



30 Compressions to 2 Breaths

- ➡ **Arouse – ask “Are you OK?”**

**Send someone to CALL 911
and get AED**

- ➡ **Unresponsive?**
Look for:
**No breathing / No normal breathing
(only gasping)**
- ➡ **Give 30 Compressions**
PUSH HARD
PUSH FAST (100 per minute)
- ➡ **Give 2 Breaths**
- ➡ **Repeat Compressions**
- ➡ **When AED arrives turn it on and
follow voice instructions**

If a student, staff member, or visitor exhibits ALLERGIC SYMPTOMS in 2 or more body systems (see below) or has difficulty breathing:

1. Send someone to get STOCK EPINEPHRINE from school office.



2. Have trained staff administer STOCK EPINEPHRINE.
Yellow for ages 9 and up. Green for ages 8 and under.

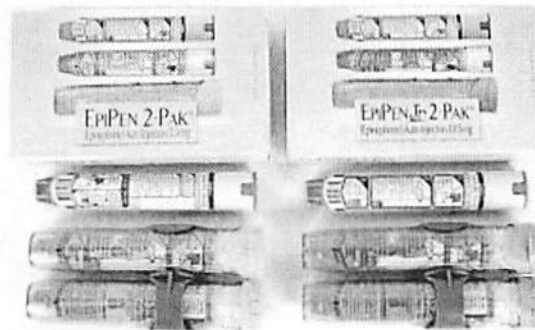

3. Call 911 and parents.

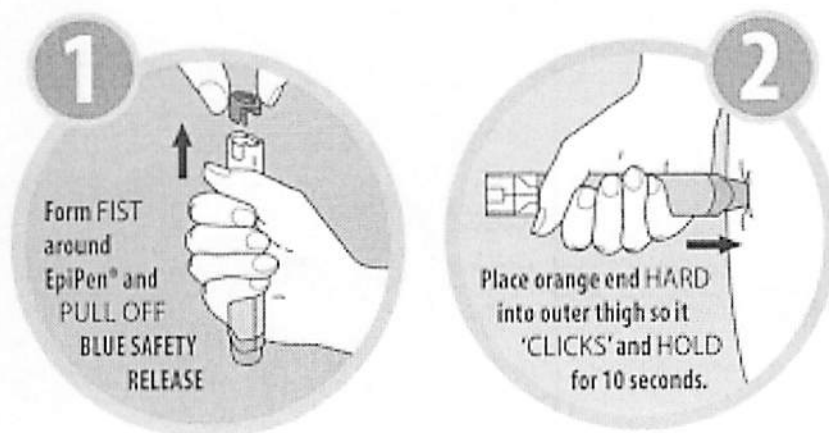

Common Signs of Severe Allergic Reaction

Mouth: tingling, itching, swelling of the lips, tongue or mouth

Throat: itching, difficulty swallowing, drooling, hoarseness

Skin: hives, itchy rash, swelling

Stomach: nausea, vomiting

Lungs: short of breath, coughing, wheezing

